

**SANDELL'S I-TRUSS REINFORCEMENT**

**PRODUCT NAME:**  
I-Truss Reinforcement

- FINISHES:**
- Mill Galvanized coating: ASTM A 641 (0.1 oz/ft)  
ASTM A 641 Class 1 (0.4 oz/ft)  
ASTM A 641 Class 3 (0.8 oz/ft)
  - Hot Dip Galvanized after fabrication:  
ASTM A 153 (1.5 oz/ft)
  - Stainless Steel:  
ASTM A 580 AISI Type 304  
(Type 316 available on special order)

- WIRE SIZE:**
- (S) Standard Weight  
9 Gauge Side Rods x 9 Gauge Cross Rods
  - (EH) Extra Heavy  
3/16" x Side Rods x 9 Gauge Cross Rods
  - (SJD) Super Heavy Duty  
3/16" x Side Rods x 3/16" Cross Rods

- BLOCK SIZE:**
- 4"  12"
  - 6"  14"
  - 8"  16"
  - 10"

Sandell's Prefabricated Hook and Eye Corners and Tees are available in the same configurations.

**I-TRUSS REINFORCEMENT:**

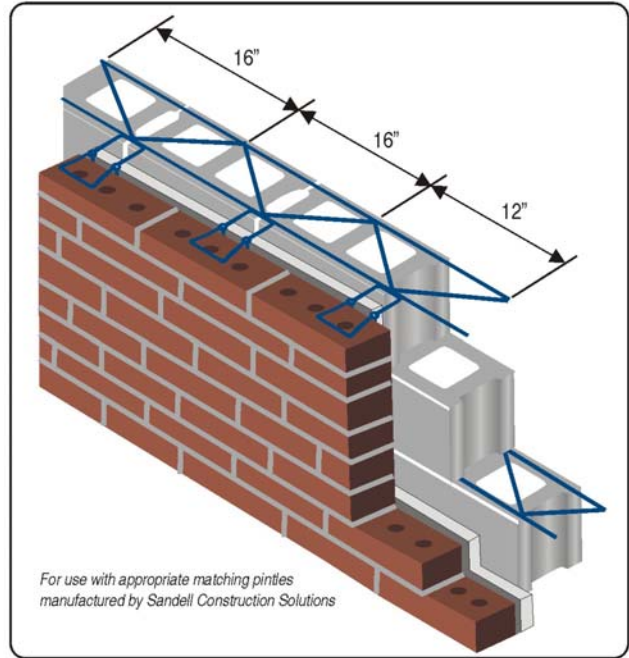

99% Post Consumer Steel  
60% Stainless Steel  
VOC Content: 0%

Amendments / Notes:

Sandell Employee:

Date:

**CORPORATE OFFICE**  
NEW YORK  
Toll Free: 800-283-3888  
Fax: 518-357-9757

**BRANCH OFFICE**  
ALABAMA  
Toll Free: 877-SANDELL  
Fax: 205-263-1033

**BRANCH OFFICE**  
WISCONSIN  
Toll Free: 800-323-3565  
Fax: 414-764-6993