

SANDELL'S I-LADDER REINFORCEMENT

PRODUCT NAME:
I-Ladder Reinforcement

- FINISHES:**
- Mill Galvanized coating: ASTM A 641 (0.1 oz/ft)
ASTM A 641 Class 1 (0.4 oz/ft)
ASTM A 641 Class 3 (0.8 oz/ft)
 - Hot Dip Galvanized after fabrication:
ASTM A 153 (1.5 oz/ft)
 - Stainless Steel:
ASTM A 580 AISI Type 304
(Type 316 available on special order)

- WIRE SIZE:**
- (S) Standard Weight
9 Gauge Side Rods x 9 Gauge Cross Rods
 - (EH) Extra Heavy
3/16" x Side Rods x 9 Gauge Cross Rods
 - (SJD) Super Heavy Duty
3/16" x Side Rods x 3/16" Cross Rods

- BLOCK SIZE:**
- | | |
|------------------------------|------------------------------|
| <input type="checkbox"/> 4" | <input type="checkbox"/> 12" |
| <input type="checkbox"/> 6" | <input type="checkbox"/> 14" |
| <input type="checkbox"/> 8" | <input type="checkbox"/> 16" |
| <input type="checkbox"/> 10" | |

Sandell's Prefabricated Hook and Eye Corners and Tees are available in the same configurations.

I-LADDER REINFORCEMENT:

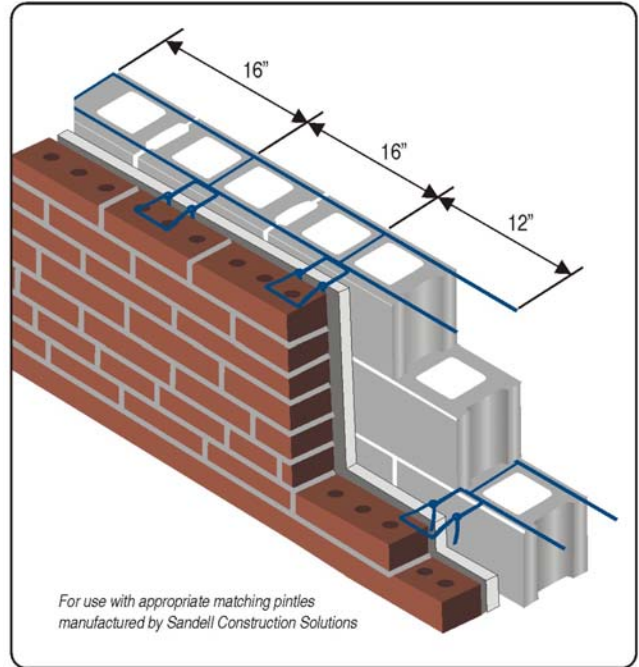

99% Post Consumer Steel
60% Stainless Steel
VOC Content: 0%

Amendments / Notes:

Sandell Employee:

Date:

CORPORATE OFFICE
NEW YORK
Toll Free: 800-283-3888
Fax: 518-357-9757

BRANCH OFFICE
ALABAMA
Toll Free: 877-SANDELL
Fax: 205-263-1033

BRANCH OFFICE
WISCONSIN
Toll Free: 800-323-3565
Fax: 414-764-6993